



Subject to change without notice!
Rev. 0901

Metal separator MESEP

Classic

Application

The detectors of the Classic series are appropriate for simple applications in all branches of industry. In contrast to many other detectors the separating system does not need compressed air supply. A high capacity electromagnet serves for engine. Due to that the device can be installed and operated nearly on any place. Just connect the detector and start operation.



Metal separator Classic

Function

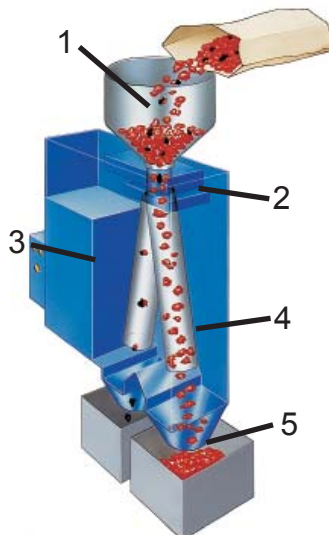

The detector is feeded with the test material via an optional hopper or a conveyor line. The sensor coil in the upper part checks it on metallic residua. If the sensor detects metal, he excites a signal directly triggering the electro-magnetic engine. By this a movable tube is powered which separates the metallic pieces from the product stream via a special outlet. Due to the electro-magnetic engine compressed air becomes redundant. Thus the device instantly is ready for operation when the operating voltage is connected.

- 1 - feeding hopper
- 2 - sensor
- 3 - electro-magnetic engine
- 4 - movable tube
- 5 - special outlet for metallic residua



Type	MESEP Classic 50
Mechanical data	
Dimensions	L x B x H: 340 x 112 x 491 mm (without funnel)
Aperture	40 mm
Material - pendular tube	Stainless steel
Material - housing	Plastic
Material - protection tube	Phenolic resin
Material - ejection flap	Linatex
Weight	13 kg
Conditions of use	
Storage temperature	-10 .. 60°C
Operating temperature	0 .. 60°C
Protection class	IP40
Electrical connection	230 V; 50 Hz oder 115 V; 60 Hz; 3 m cable 3 x 1,5 mm ²
max. drop height of the bulk material	0 .. 1000 mm (from top edge - without funnel)
Troughput ³	1.300 l/h
Sensitivity ¹	Ferrous = 1,0 mm
Ordering information	
Ordering number	230VAC; 50Hz → 08419100000; 115VAC; 60Hz → 08419100031
Funnel (optional)	08410001900

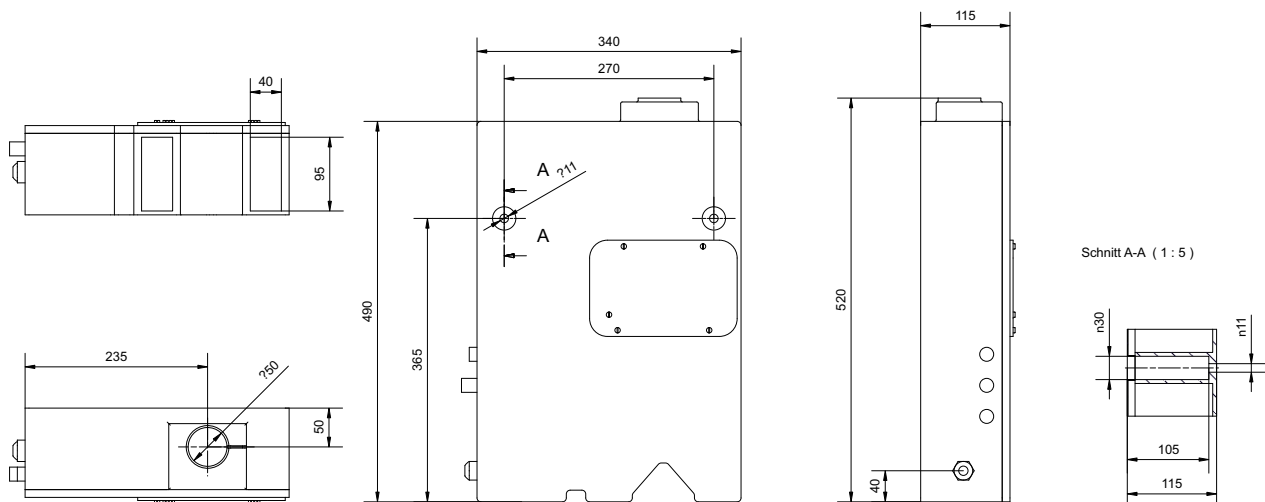

¹ The actual sensitivity depends on various factors. Unfavourable environmental conditions or vibrations can decrease the sensitivity.
³ Measured with granulate PET - grain dimension 2 - 4 mm.